

Model WF3EZ

3000-GALLON CAPACITY

EZ DOOR® PFAS WATER FILTER

NSF/ANSI, PFAS, Lead, Bacteria, Chlorine, Microplastics

TECHNICAL ASSISTANCE TOLL FREE TELEPHONE NUMBER:

(800) 742-8259

Technical Assistance E-Mail: FieldService@AcornEng.com

[LINK 3000 Gallon PFAS Filter Certifications](#)

FILTER WARRANTY INFORMATION

www.murdockmfg.com/terms-and-warranty



NOTE: Intended for initial installation of WF3EZ.

For replacement Filter: Use model RWF3000. Refer to RWF3000 Product Page for Submittal and Installation Manual.

PREPARATION

- Intended for units with WF1EZ/WF3EZ Filter Access:** Remove Housing Skirt Panel [1]. Shut off unit water supply using Shut-Off Valve by Others (**DETAIL A**).

Remove EZ Door® Filter Access Panel [2] and discard. Set aside the Screws for reassembly.

- Locate Water Supply Line [3]** through the opening of the Filter Access Panel. Remove and Discard Push-In Coupler [10] Fitting to insert Filter.

Disconnecting The Push-In Fitting: (DETAIL B) Ensure that the water supply is turned off. Using Fixture Universal Tool, push collet square towards the push-in fitting body and hold. While pushing the collet in, pull on the PE tubing to remove from the push-in fitting. Repeat for opposite side.

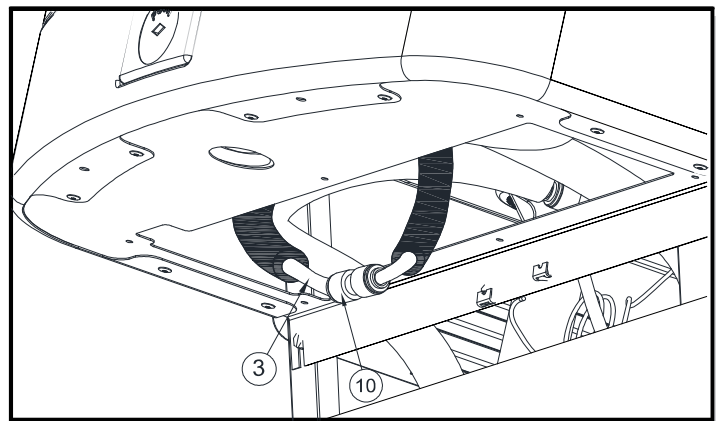
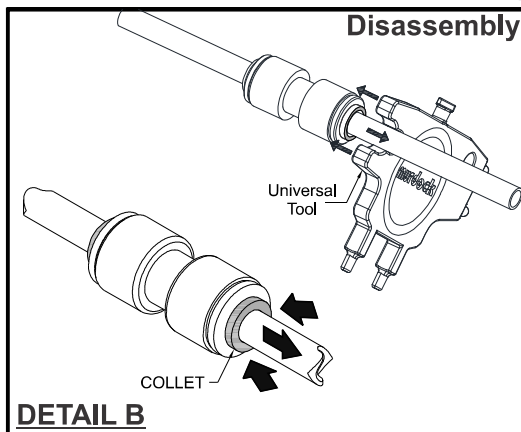
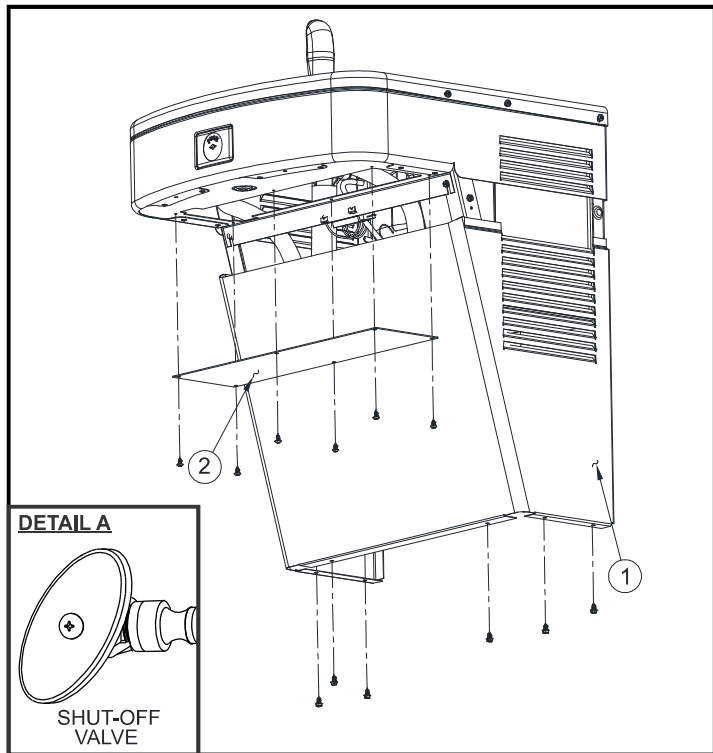

INSTALLING FILTER ASSEMBLY

3 Inserting The Tube: First pressed firmly and fully insert the Inlet from supply line tubing end into the push-in fitting [5] up to the tube stop located approximately ½" deep. Gently pull on the fitted tubing to ensure it is secure. **(DETAIL C)** Tube should not come free from the fitting. Water test the connection assembly prior to leaving the site to ensure there are no leaks.



IMPORTANT
Note: Insert water line on push-in stem with it corresponding flow line.



HINT: Remove Filter Cartridge first for easier installation.

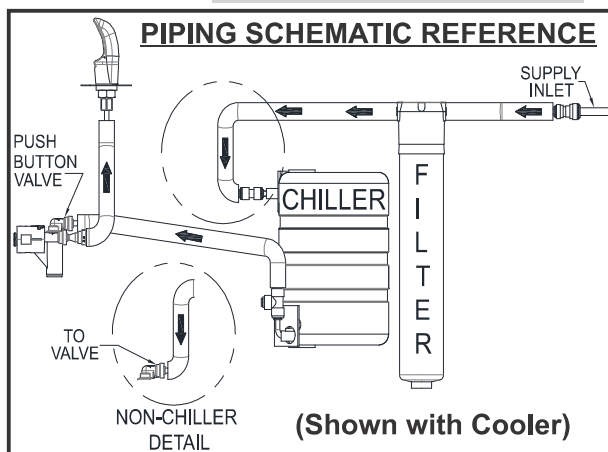
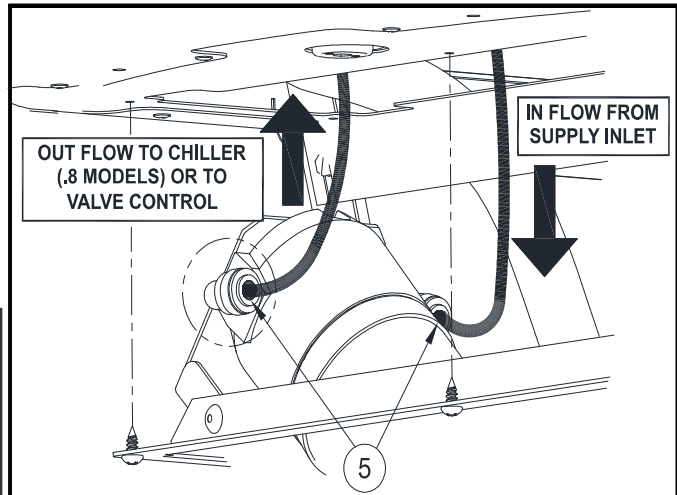
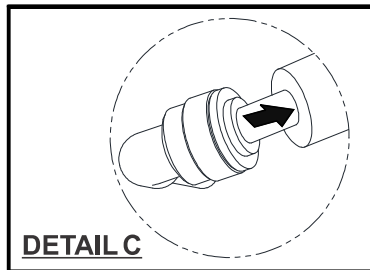

4 Install Filter Frame [6] by assembling the (6) #8 x 3/8" Long Stainless Steel Screws [7] provided.

Reinstall Filter Cartridge [8] back into Filter Cap by rotating Filter Cartridge **clockwise one quarter turn** to lock into place.

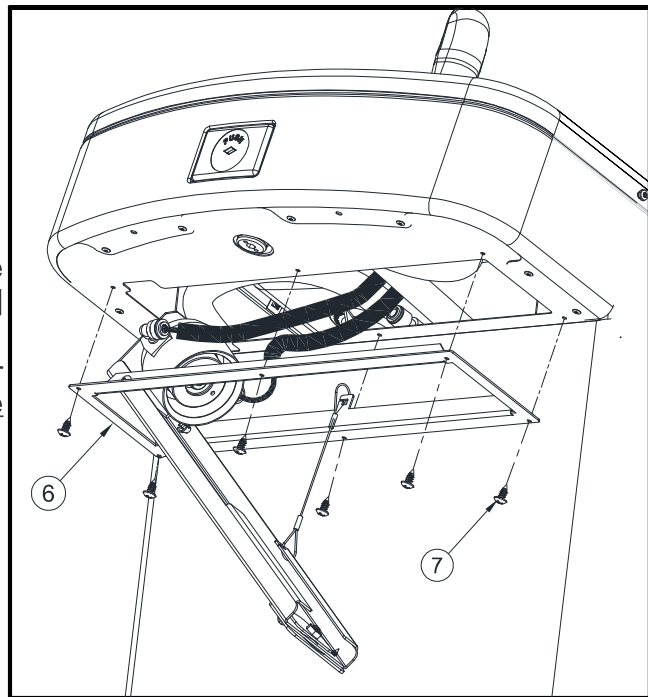
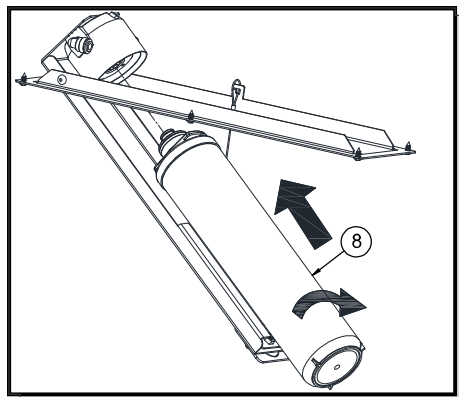

IMPORTANT
Filter Heads differ for WF1EZ 1500-Gallon and WF3EZ 3000 Gallon EZ Door® assemblies.

COMPLETING FILTER INSTALLATION

5 Lock **WF3EZ Filter Latch** [9] after installation is complete using the Fixture Maintenance Tool (**DETAIL D**).

NOTE: Fixture Maintenance Tool Required to Open and Close Latch. Provided with Drinking Fountain.

DETAIL D

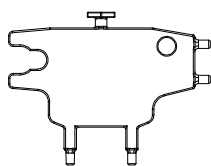

STANDARD PN: 7003-830-000

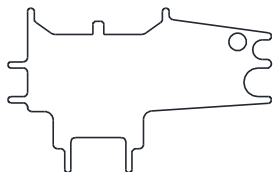

VR UNITS PN: 7003-194-199

Fixture Maintenance Tool

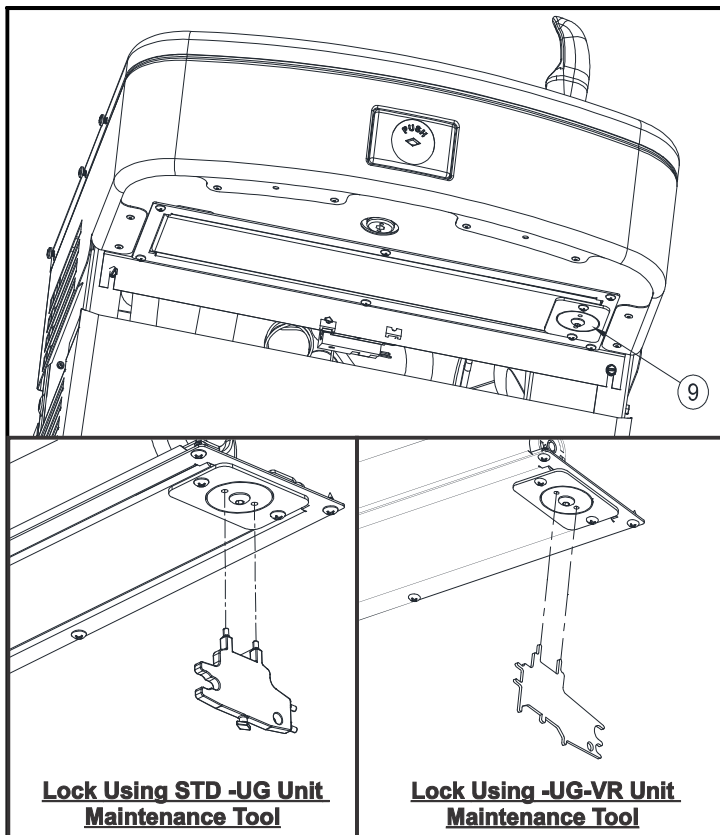

Lock Using STD -UG Unit Maintenance Tool

Lock Using -UG-VR Unit Maintenance Tool

6 Turn Back On the Shut-Off Valve (**DETAIL A**).

When Needed Reassemble Housing Skirt Panel [11] by screwing back its 6 screws after installation is successful.



IMPORTANT

Note: Check for any leaks after turning back on the Angle Stop Valve before continuing with further future installation.

7 Flush Filter - Activate Fixture, flush TOTAL of approx 6 Gallons (23 Liters):

1. If using Drinking Bubbler, flush for 12 Minutes.
2. If using Bottle Filler, flush for 6 Minutes



REPLACEMENT FILTERS: Refer to Murdock[®] Accessory RWF3000 for Replacement 3000-Gallon Filter (sold separately).

